



STEP 1 – PRIOR TO INSTALLATION

- A) Husky®** only approves installing the flares according to these written instructions with the hardware provided. **WARNING:** Failure to install according to these instructions will invalidate the warranty. This includes, but is not limited to using alternative installation methods, hardware, or materials. **DO NOT USE:** Loctite, SuperGlue, or similar products on the hardware or the flares.
- B) Fit:** Verify the fit of the flares to vehicle. (Some filing, sanding, or cutting may be necessary to ensure proper fit).
- C) Painting:** (Optional) if paint is desired it must be done prior to installing flares on vehicle. Clean outer surface with a good grade degreaser. **DO NOT USE LACQUER THINNER OR ENAMEL REDUCER AS A DEGREASER.** Wipe outer surface thoroughly with a tack rag prior to paint. Application of plastic adhesion promoter for ABS plastic as per your paint system manufacturer's recommendations is required. Paint flares using a high quality enamel, or polyurethane automotive paint. If painting edge trim (not recommended), use a flex additive.
- D) Performance:** Using larger Tires may increase the area required to turn the vehicle. Some Tire/Rim combinations may require lowering bump stops and or installing steering stops to prevent tire from contacting flare.
- E) Exhaust System:** Modifications may be necessary to maintain a minimum 4" clearance between flares and exhaust pipes. (Exhaust gases should not vent directly onto flares)
- F) Metal Protection:** All exposed fasteners and bare metal should be treated with rust resistant paint **BEFORE** installing flares. Spray inner fender wells with undercoating **AFTER** flare attachments have been completed.
- G) Decals:** Flares may interfere with existing decals on vehicle. If you wish, remove decals prior to installation of flares.
- H) Care & Cleaning:** Husky fender flares are built to last; any detergent you use to wash your vehicle is sufficient to clean the flare. Do not use any harsh abrasive detergents.

Ford Fender Flares Set of 4

Set Part #2802962
#2802963
#2802964
#2802968
#2802972

Rev-6 01/25/2024

TOOLS FOR EASY INSTALLATION:

- Utility Knife
- #2 Phillips Screwdriver
- Wrench Set
- Socket Wrench Set
- Grease Pencil
- Masking Tape

PLEASE READ: Dirt and debris can become lodged between the fender flares and the vehicle's fenders, causing scratching and paint wear from vibration. Husky is not responsible for any damage, and the installation of our fender flares is done with the buyer's understanding that this scratching and paint wear may occur.

3 YEAR LIMITED WARRANTY AGAINST ANY MANUFACTURING DEFECTS

- To claim a warranty, you must provide Proof of Purchase.



The material that your product is made from can be recycled. Please also consider recycling the packaging that your product came in.



Included in Hardware Kit:

- | | | | | | | |
|--|---|---|--|---|--|---|
| 1.

SW1-0067,
5/16 x 18 x 3/8"
SS Torx Screw,
(Pocket Style Only)
34 pcs | 2.

WA1-0012,
.320 x .700 x .03
SS Washer,
(Pocket Style Only)
34 pcs | 3.

NU1-0019,
5/16-18 Jam Fin.
Nylock Nut,
(Pocket Style Only)
34 pcs | 4.

SW1-0052,
T-45 Torx Bit,
(Pocket Style Only)
1 pc | 5.

SW1-0058,
#10 x 5/8" Phillips
SS Truss Screw,
20 pcs | 6.

SW1-0050,
10 x 5/16 Phillips
Truss Screw,
6 pcs | 7.

CL1-0009,
Long "U" Clip,
Magni 565
2 pcs |
| 8.

CL1-0005,
Dacromet "S"
Spring Clip,
6 pcs | 9.

MT1-0014,
1" x 1.5" x .01"
Black Mylar Tab,
6 pcs | 10.

MT1-0034,
1" x 1.5" x .06"
Blk 3M Foam Tab,
2 pcs | 11.

ET1-0002,
Edge Trim Tool,
1 pc | 12.

GP1-0025
Edge Trim
348 in. | 13.

CL1-0022,
#10 "U" Clip,
12 pcs | |

Component List:

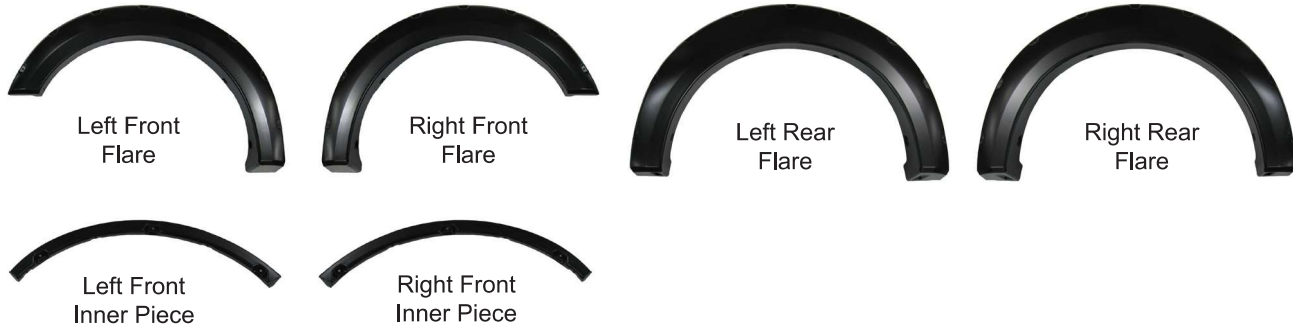

If your flares already have the edge trim and pocket hardware installed, skip to Front Flare Installation Step 4.

STEP 2 - EDGE TRIM INSTALLATION

A. Peel two to three inches of red vinyl backing away from Edge Trim (GP1-0025) tape. Applying the adhesive side of the edge trim to the inner side of the flare, affix the edge trim to the top edge of the flare (the portion that comes in contact with the vehicle).

B. Press edge trim into place along the top edge of the flare in one-foot increments, pulling red vinyl backing free as you continue to work your way around the top edge of the flare.



Pocket Hardware Installation (Pocket Style Only):



Put a Washer (WA1-0029) on each Bolt (SW1-0087).

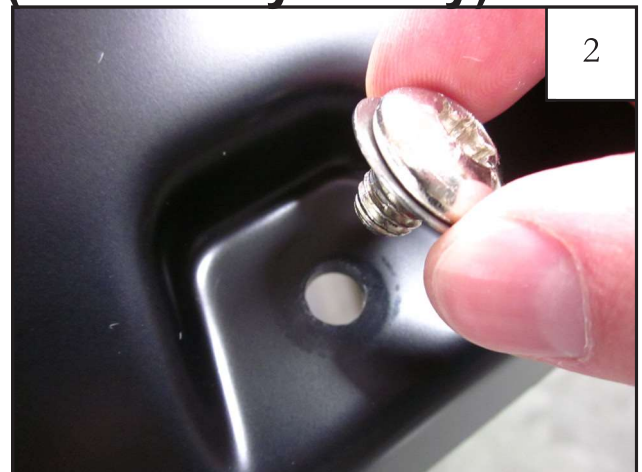

Put each Bolt/Washer combination through a pocket hole in the flare, Bolt head and Washer on the outside.



3

Place a Nut (NU1-0019) over the end of each Bolt and tighten, using a 1/2" wrench for the Nut and the supplied Torx Bit (SW1-0052) for the Bolt. Repeat for remaining pockets.

Front Flare Installation Procedures (Passenger's Side):



4

Remove seven factory screws with a socket wrench. Note (1) location where screw is not to be removed. Save screws for reinstallation.



5

If applicable: Add clip (CL1-0022) to flange if there is no screw at that location.



6

Hold flare to vehicle and mark one flare hole location with a grease pencil.

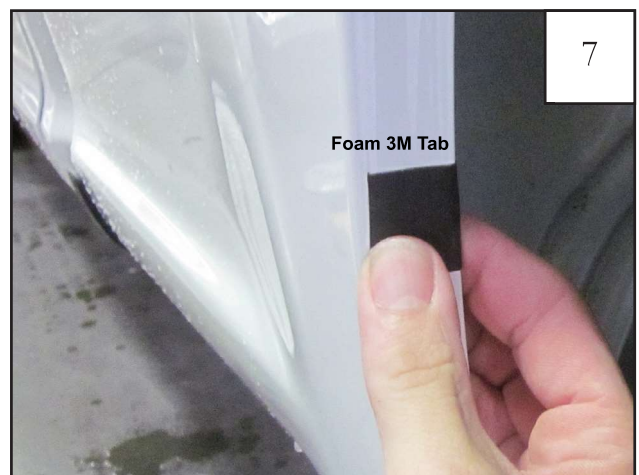

7

Wrap a Foam Tab (MT1-0034) around the wheel well sheet metal, centered over the mark made in Step 6.



8

Install a Clip (CL1-0009) over the Tab (MT1-0034) placed in Step 7.



9

Verify presence of U-clip on inner brackets.



10

Line up the holes in the inner piece with the three uppermost factory holes. *NOTE: Both inner brackets are universal.*

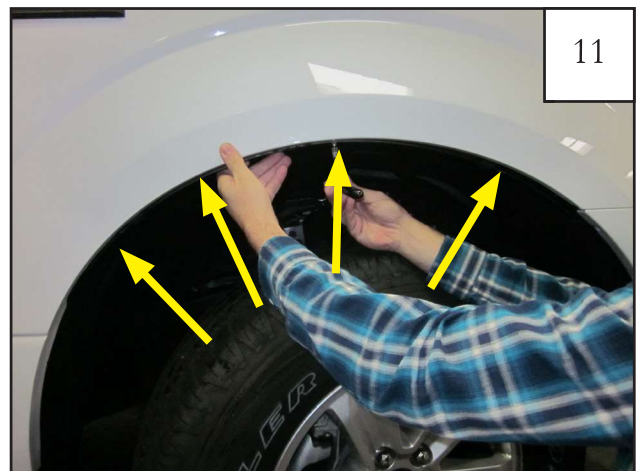

11

Using a socket wrench, reinstall the factory screws through the inner piece.



12

Hold flare to fender, re-install three factory screws removed in Step 4 using sockets and wrench.



13

Position flare on fender, pressing inward on the flare, line up the flare mounting holes with the mounting clips on the inner piece. Install four Phillips Truss Screws (SW1-0058) through the flare and into the clips on the inner piece. Install and tighten.



Completed front flare installation.

Rear Flare Installation Procedures (Passenger's Side):

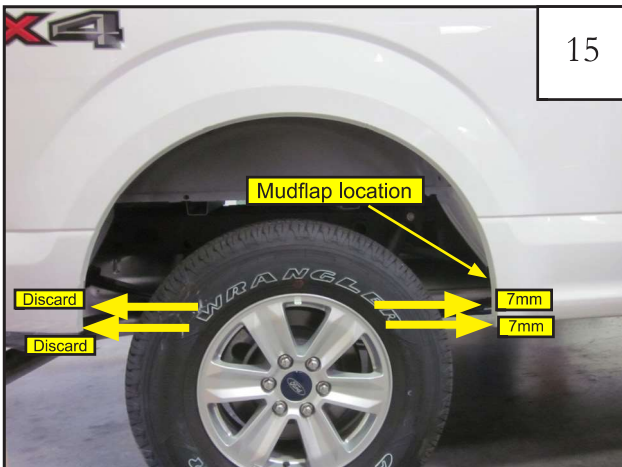

Remove and discard factory mudflap in front of wheel well opening. Remove four factory fasteners from rear of wheel well. Retain two 7mm screws for reinstallation. Thoroughly clean the vehicle sheet metal and inner flange prior to installation.



Hold flare to vehicle and mark three flare hole locations with a grease pencil.



Wrap a Mylar Tab (MT1-0014) around the wheel well sheet metal, centered over each of the three marks made in Step 16.



Tab locations

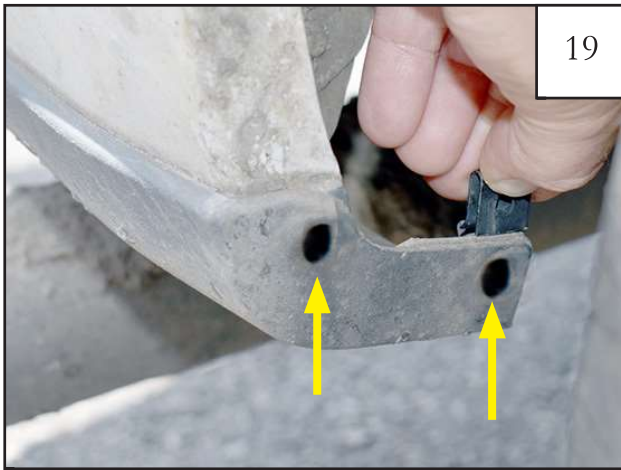

19

Install two clips (CL1-0022) at lower rear wheel well area.

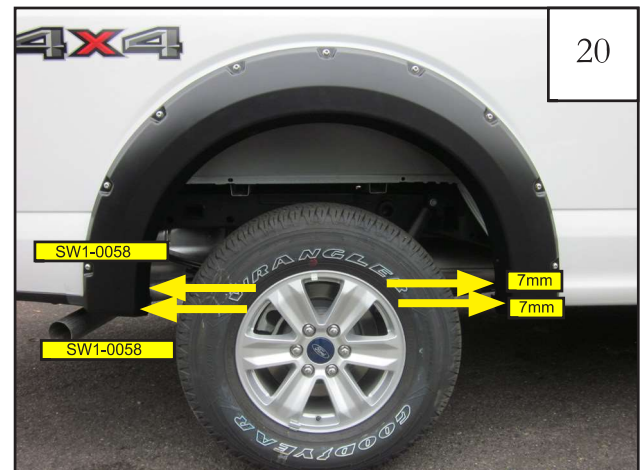

20

Reinstall two factory 7mm screws. Install two truss screws (SW1-0058).



21

Press flares firmly onto the vehicle and install and fully tighten three screws (SW1-0050) into the clips installed in step 18.



22

Completed rear flare installation.

Edge Trim Tool Procedures:



23

Using supplied Edge Trim Tool (ET1-0002), seat edge trim against vehicle by hooking curved end under edge trim at one end of flare. Next, slide around outer edge of flare to the other end.



24

Using flat end of supplied Edge Trim Tool (ET1-0002), seat edge trim against flare by inserting straight end between edge trim and flare at one end. Next, slide around entire edge to the other end.